

# RVN Nordic – for cold and demanding climates

New combined air intake and exhaust wall grille in the NORDexternal product family

## Key features

- Insulated exhaust air duct** helps prevent freezing and icicle formation
- Exhaust air velocity** at least 5 m/s (with correct adjustment setting)
- Separated airflows** prevent air mixing
- Reversible configuration** for flexible installation
- Powder-coated** galvanized steel casing ensures high weather resistance

## RVN NORDIC

Designed for cold and demanding climates – the construction reduces the risk of freezing and condensation and ensures reliable year-round operation.

 **NORDexternal**

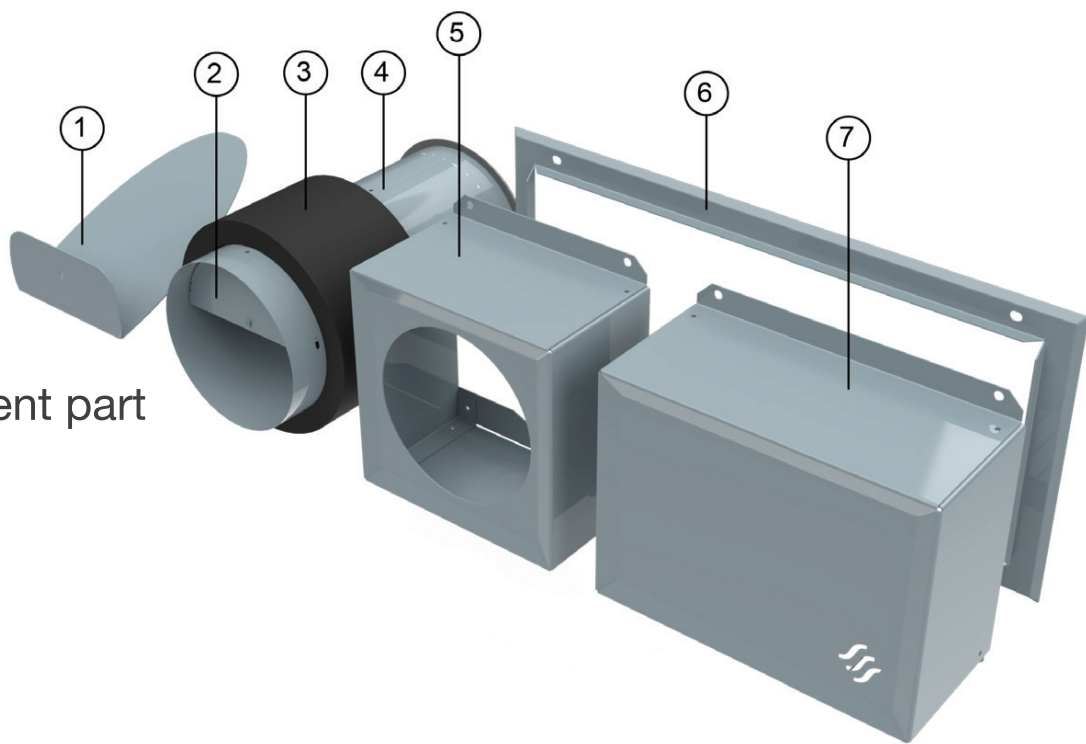

- 1 – Additional adjustment part
- 2 – Adjustment part
- 3 – Armaflex 19mm
- 4 – Exhaust air duct
- 5 – Exhaust air casing
- 6 – Frame
- 7 – Supply air casing

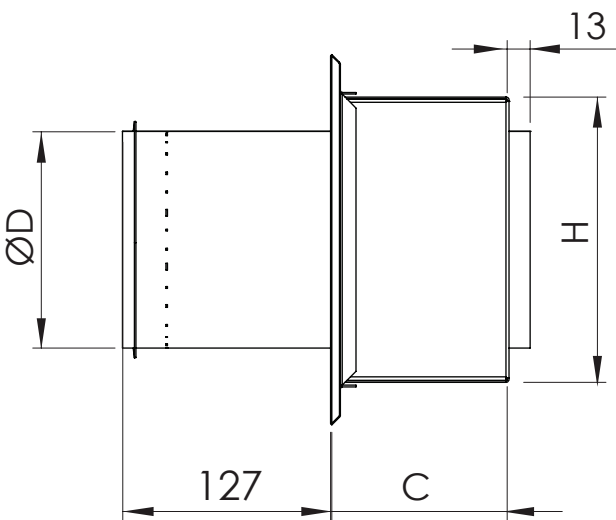
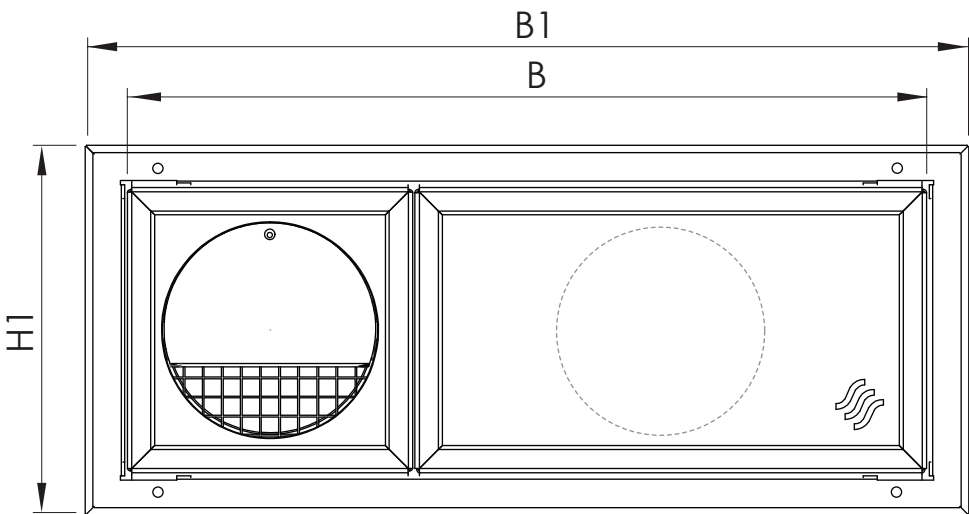

Product	D (mm)	B (mm)	H (mm)	H1 (mm)	B1 (mm)	C (mm)	Airflow (l/s)
RVN 125	125	459	164	213	509	103	18-32
RVN 160	160	587	196	247	634	152	30-55
RVN 200	200	669	239	288	716	201	50-80
RVN 250	250	829	287	338	875	271	75-125

