

**NPSK-T Saddle**

Saddle with seal to fit round duct.

Nominal size D-d	h, mm	l <sub>p</sub> mm	Weight, kg
500-200	270	30	0,40
500-250	270	50	0,52
500-315	270	50	0,83
630-160	335	30	0,35
630-200	335	30	0,40
630-250	335	50	0,55
630-315	335	50	0,75
800-250	420	50	0,6
800-315	420	50	0,8

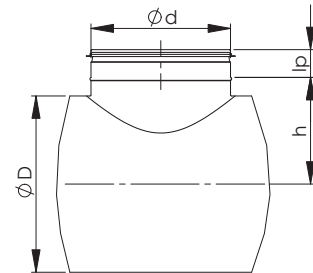

**Product code**

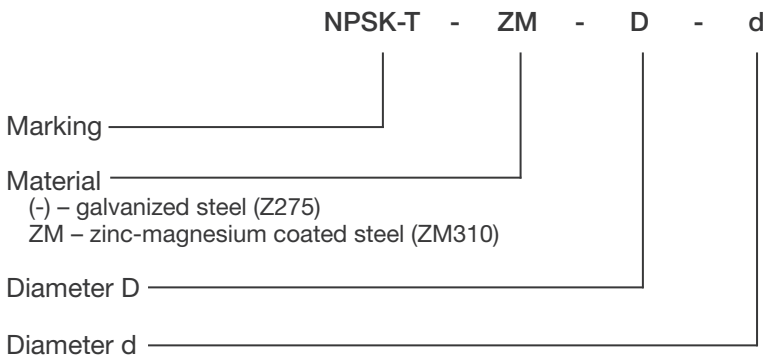

Example: NPSK-T 500-315