

RVDV Outdoor wall-mounted exhaust grille

- Unique and stylish outdoor exhaust grill available in all RAL colors
- Compact and flat - fits easily on all exterior surfaces
- Focused exhaust flow pattern
- Low pressure drop - reduces fan energy consumption
- Galvanised steel housing with powder coating ensures long-term durability



Application

RVDV is an ideal device to solve exhaust air requirements of apartment houses to be renovated.

Structure and dimensions

In standard configuration, RVDV grilles are manufactured from galvanized steel and finished with a grey RAL 7000 powder coating.

RVDV is optionally available in all RAL- series colors.

Exhaust duct connections are provided with rubber gasket and mesh screen.

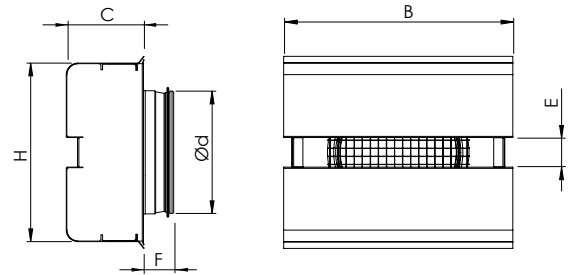

Product	Ød, mm	B, mm	H, mm	C, mm	E, mm	F, mm	Weight, kg
RVDV 125	125	244	198	86	31	39	1,5
RVDV 160	160	299	233	101	39	39	2,0
RVDV 200	200	348	273	121	43	39	2,8
RVDV 250	250	408	323	144	51	42	3,8
RVDV 250L	250	507	362	161	60	42	5,1

Technical data

Exhaust air - Pressure drop - Airflow

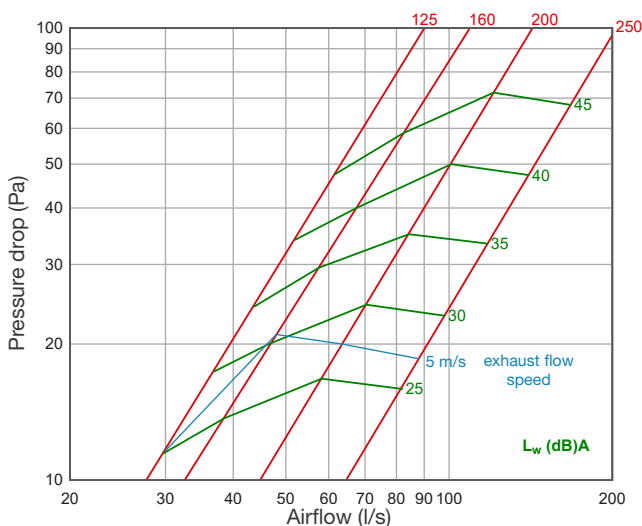

Acoustic data

$$L_w = L_{wA} + K_{okt}$$

RVDV, exhaust air	Sound level correction factor K_{okt} (dB)							
	Mean frequency of octave band (Hz)							
	63	125	250	500	1k	2k	4k	8k
RVDV 125	1	-1	1	-1	-9	-15	-16	-16
RVDV 160	0	0	0	-1	-9	-14	-16	-16
RVDV 200	-1	-1	2	-1	-5	-13	-22	-25
RVDV 250	2	2	1	-1	-6	-12	-22	-24
RVDV 250L	0	2	0	-0	-6	-11	-20	-22

Sound attenuation

RVDV, exhaust air	Sound attenuation D_{okt} (dB)							
	63	125	250	500	1k	2k	4k	8k
RVDV 125	21	14	11	7	7	4	4	6
RVDV 160	18	11	9	6	4	5	5	5
RVDV 200	17	10	7	4	3	3	5	5
RVDV 250	15	10	6	3	3	5	5	5
RVDV 250L	14	9	5	3	3	4	5	5

Airflow pattern

RVDV 125, side view

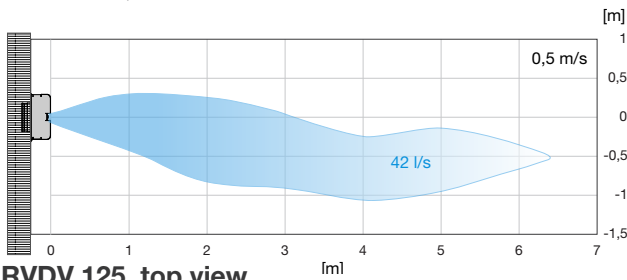

RVDV 125, top view

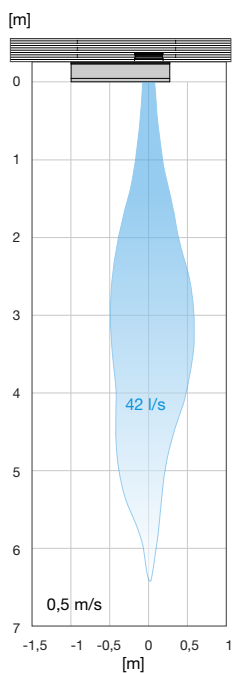

RVDV 160, side view

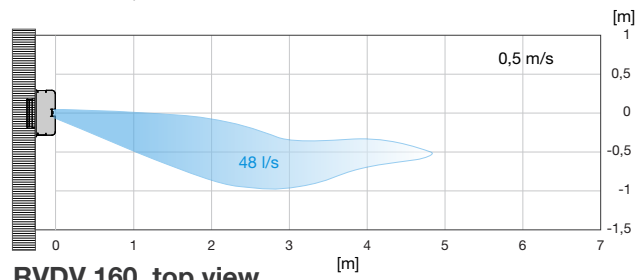

RVDV 160, top view

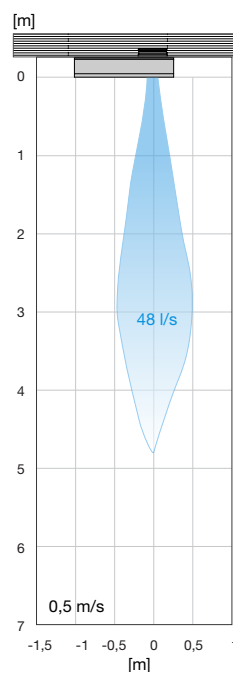

Marking

RVDV - d - RAL 7000

Product

RVDV - exhaust air grille

Nominal size

RAL Color Code

RAL color: if other than standard color (standard color RAL 7000, light grey)

Example: RVDV 160