

**RVDS Outdoor wall-mounted intake grille**

- Unique and stylish outdoor intake grill available in all RAL colors
- Compact and flat - fits easily on all exterior surfaces
- Air intake from the underside prevents entry of water or snow into the supply duct
- Galvanised steel housing with powder coating ensures long-term durability

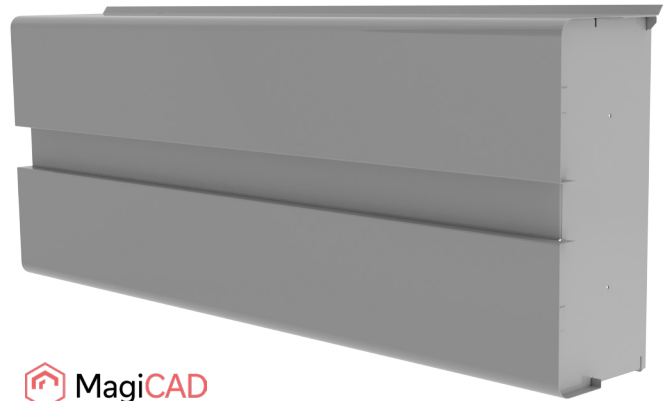

**Application**

RVDS is the ideal solution for residential buildings where ventilation is local to each apartment.



**Structure and dimensions**

In standard configuration, RVDS grilles are manufactured from galvanized steel and finished with a grey RAL 7000 powder coating. RVDS is optionally available in all RAL- series colors.

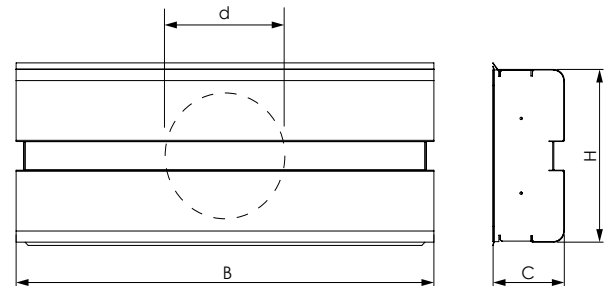

Product	Wall opening d mm	B, mm	H, mm	C, mm	Weight, kg
RVDS 125	125	433	198	86	1,6
RVDS 160	160	591	233	101	2,5
RVDS 200	200	681	273	121	3,4
RVDS 250	250	849	323	144	5,0

**Technical data**

**Intake air - Pressure drop - Airflow**

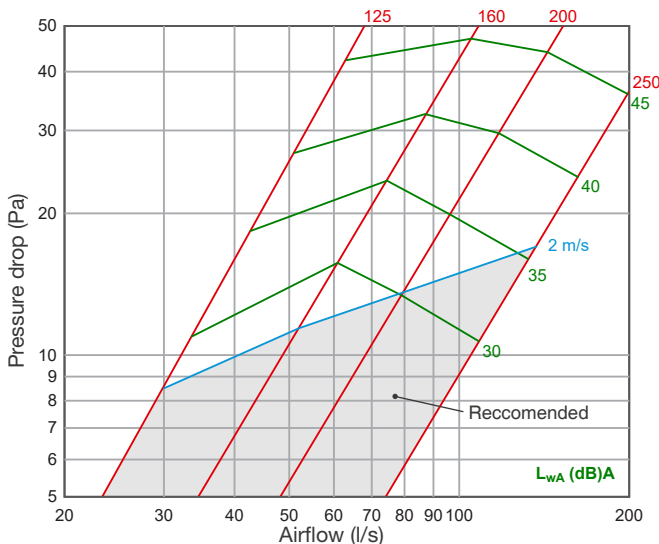

**Acoustic data**

$L_w = L_{wA} + K_{okt}$

RVDS, intake air	Sound level correction factor $K_{okt}$ (dB)							
	Mean frequency of octave band (Hz)							
	63	125	250	500	1k	2k	4k	8k
RVDS 125	2	-4	0	-2	-8	-14	-15	-14
RVDS 160	0	-3	-1	-1	-6	-11	-15	-14
RVDS 200	-7	-6	-3	-1	-5	-12	-15	-20
RVDS 250	-1	1	2	-2	-6	-10	-15	-22

**Sound attenuation**

RVDS, intake air	Sound attenuation $D_{okt}$ (dB)							
	63	125	250	500	1k	2k	4k	8k
RVD 125	19	13	8	8	7	7	5	5
RVD 160	17	12	6	8	6	5	5	6
RVD 200	16	10	5	6	4	4	5	5
RVD 250	13	8	3	4	4	4	4	5

**Marking**

RVDS - d - RAL 7000

Product ————  
RVDS - intake air grille

Nominal size ————

RAL Color Code ————  
RAL color: if other than standard color (standard color RAL 7000, light grey)

**Example: RVDS 160**