

TL3 Maintenance Door for Round Duct

Maintenance door with quick release for round duct.
 The maximum operating temperature of the TL3 is 70°C.
 Maintenance doors meet requirements for tightness class C (EN 12237:2003).



Measurements

Nominal size ØD (mm)	Opening size AxB (mm)	Material (mm)	
100-160	185x85	0,7	One handle
200-315	300x100	0,7	Two handles
400-500	400x200	1,0	Two handles
630-1250	500x400	1,2	Two handles

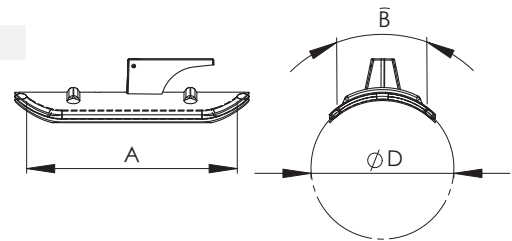

Product Marking

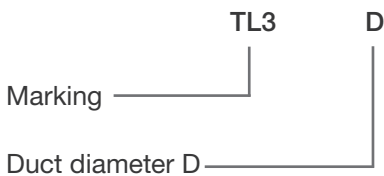

Example: TL3 315