

MRKA/MRPA/MRCA Rectangular Openable Silencer

Openable rectangular silencer for rectangular duct systems. Suitable for use in exhaust, intake, discharge and supply air handling systems.

Fulfils tightness class C.

The elements are available in widths 100, 150 and 200 mm.

Standard lengths of rectangular silencers are 1250 and 2000 mm.



Design and Dimensions

The MRKA/MRPA/MRCA is manufactured with an insulated outer shell, an aluminum frame, absorption elements and a hatch. The hatch is equipped with universal hinges that allow the hatch to be opened from the right or left side or removed completely. The MRKA/MRPA/MRCA-silencer's outer shell is made of galvanized sheet steel and is equipped with an E20-europrofile.

Dimensions A and B are the silencer's duct connection dimensions.

The absorption elements are removable and can be cleaned using dry cleaning methods or if necessary with a damp cloth.

MRKA - absorption material mineral wool.

MRPA - absorption material synthetic sound insulation.

MRCA - absorption material Cleantec® mineral wool with washable surface layer.

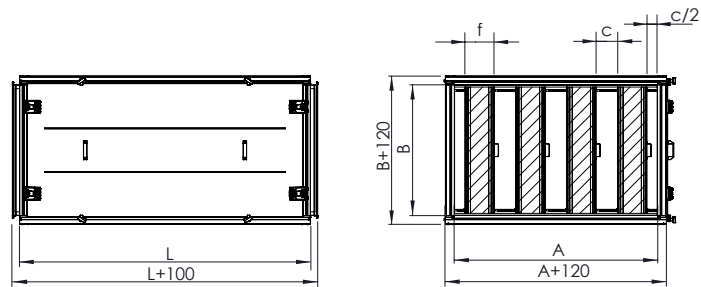

MRKA/MRCA sound attenuation (absorption material mineral wool)

(Width A= 400, 600, 800, 1000, 1200, 1400, 1600, 1800, 2000, 2200, 2400)

Element width f (mm)	Elements spacing c (mm)	Lenght L (mm)	Sound attenuation (dB)							
			Mean frequency of octave band (Hz)							
			63	125	250	500	1k	2k	4k	8k
100	100	600	1	2	6	14	29	23	17	10
		900	2	3	7	18	40	29	21	12
		1250	3	5	9	23	49	37	26	15
		1500	3	6	10	29	50	43	31	18
		1800	4	6	11	34	50	46	35	20
		2000	5	8	13	39	50	49	40	23
200	100	600	2	5	13	21	27	22	18	13
		900	3	8	20	31	29	26	23	17
		1250	4	11	26	45	47	37	29	19
		1500	5	14	32	47	49	42	35	22
		1800	7	16	38	50	50	47	38	25
		2000	8	18	43	50	50	50	41	28

MRPA sound attenuation (absorption material synthetic sound insulation)

(Width A= 400, 600, 800, 1000, 1200, 1400, 1600, 1800, 2000, 2200, 2400)

Element width f (mm)	Elements spacing c (mm)	Lenght L (mm)	Sound attenuation (dB)							
			Mean frequency of octave band (Hz)							
			63	125	250	500	1k	2k	4k	8k
100	100	600	1	2	6	10	19	19	15	11
		900	2	3	7	11	24	20	16	12
		1250	2	5	9	17	33	31	22	19
		1500	3	6	12	21	42	36	26	21
		1800	5	7	14	25	47	41	31	25
		2000	6	10	16	29	50	45	36	28
			63	125	250	500	1k	2k	4k	8k
200	100	600	3	5	12	22	23	16	14	12
		900	4	8	15	26	32	23	19	15
		1250	5	11	18	34	41	31	23	19
		1500	6	13	24	42	45	37	29	21
		1800	7	15	28	45	49	42	33	24
		2000	8	17	32	48	50	47	37	27

Product Marking

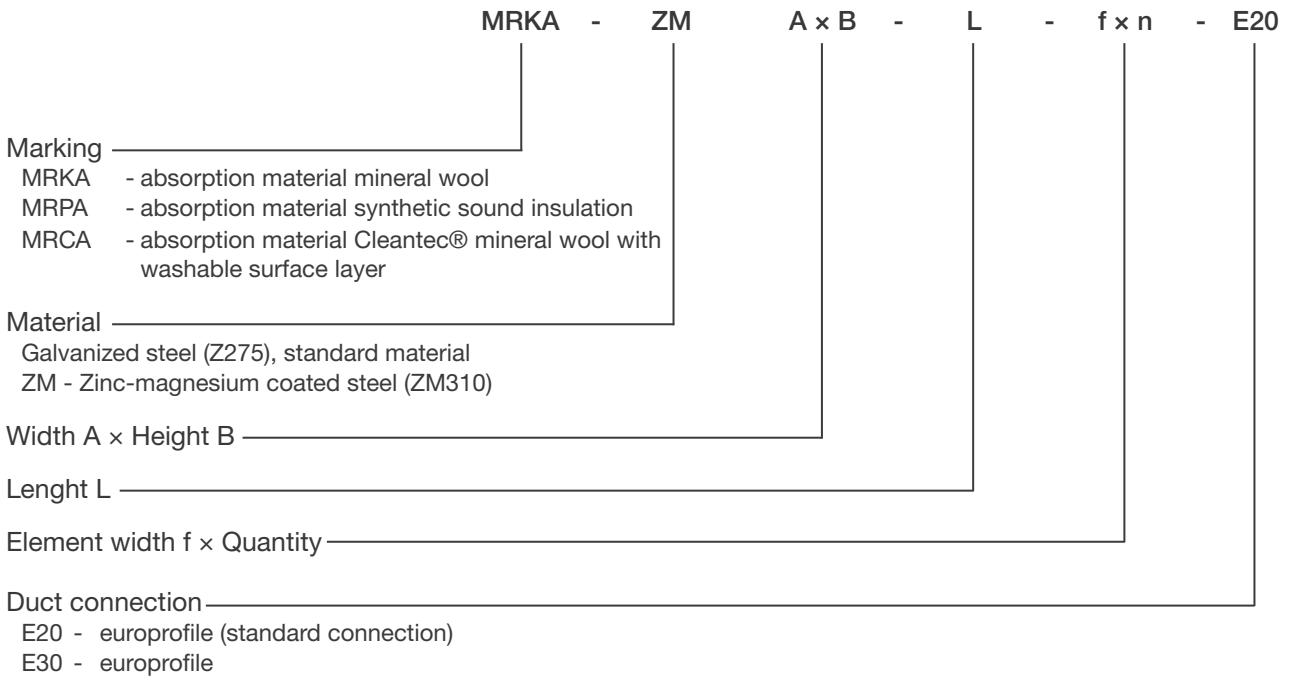

Example: MRKA 600x400-1000-100x3-E20

MRPA 600x400-1000-100x3-E20