

NORDcanopy

HN Installation, use and maintenance manual

www.nordcooking.com

Contents

1. In the kit	3
2. Safety	4
3. Removing the ceiling panel (Optional)	4
4. Hanging the kitchen canopy	4
5. Leveling the canopy	5
6. Opening the front panel	5
7. Fastening kitchen canopy sections together	6
8. Lighting connection	7
9. Adjusting airflow	8
10. Replacing the luminaires	9
11. Canopy maintenance	9
12. Accessories	10

1. In the kit

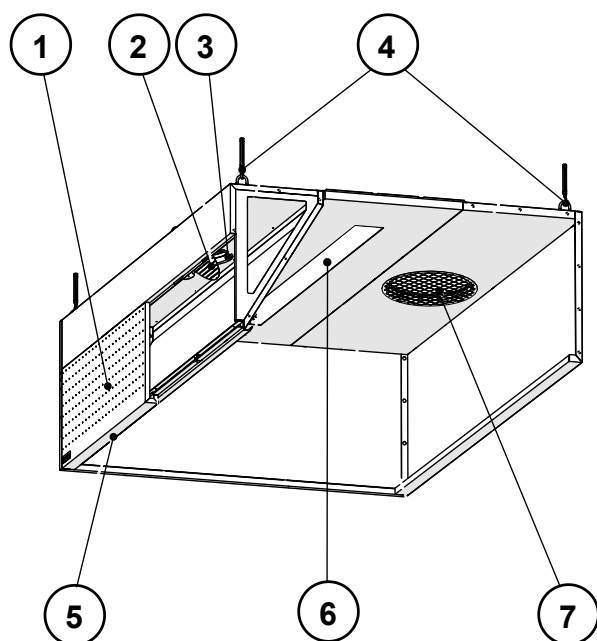

- 1 – Front panel
- 2 – Supply air regulating plate
- 3 – Supply air connection
- 4 – Suspension points
- 5 – Front panel lock
- 6 – Lighting
- 7 – Exhaust air connection

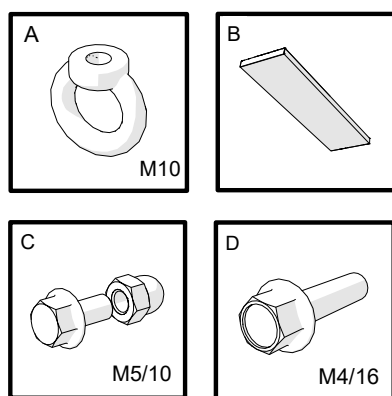

In the kit:

- A – Loop nut
- B – Ceiling panel for sequential connection
- C – Bolts and cap nuts
- D – Screws

1.1 Measurements

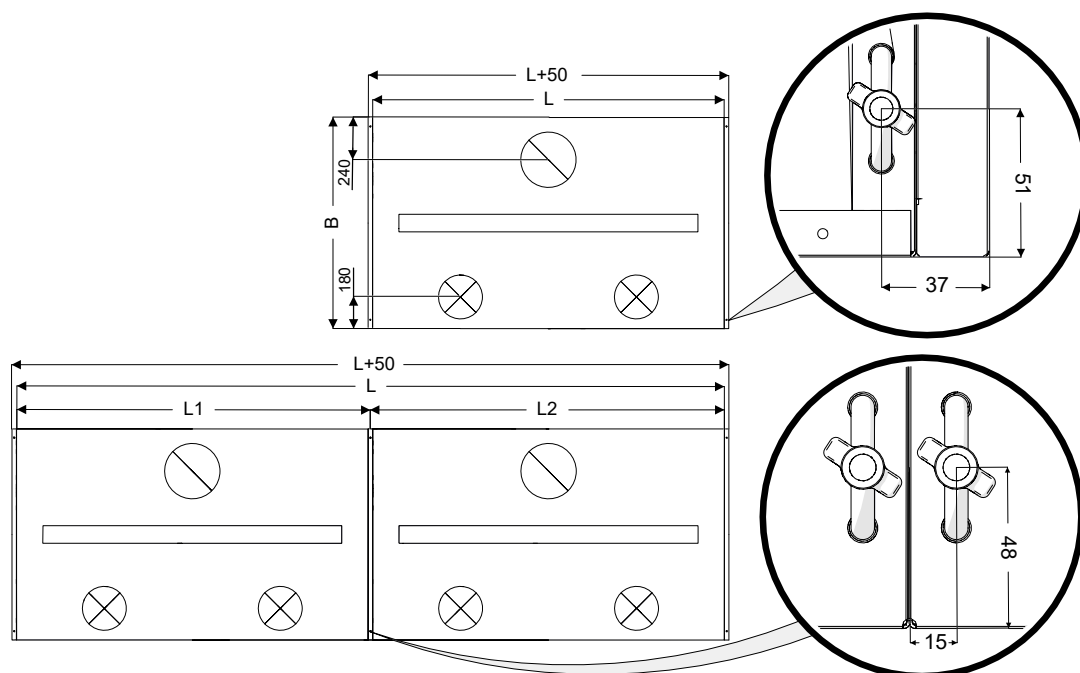

2. Safety

It is prohibited to hold or add additional weight on the top of the canopy.

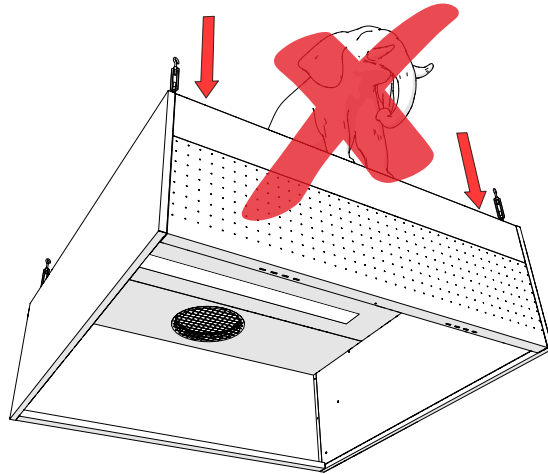

3. Removing the ceiling panel (optional)

With larger canopies, removing the center ceiling panel can provide better access for exhaust duct and insulation installation.

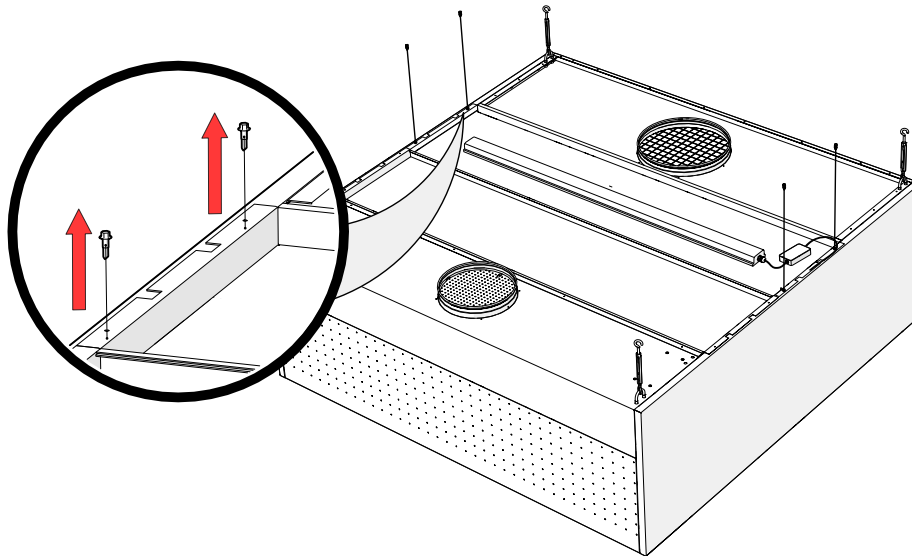

4. Hanging the kitchen canopy

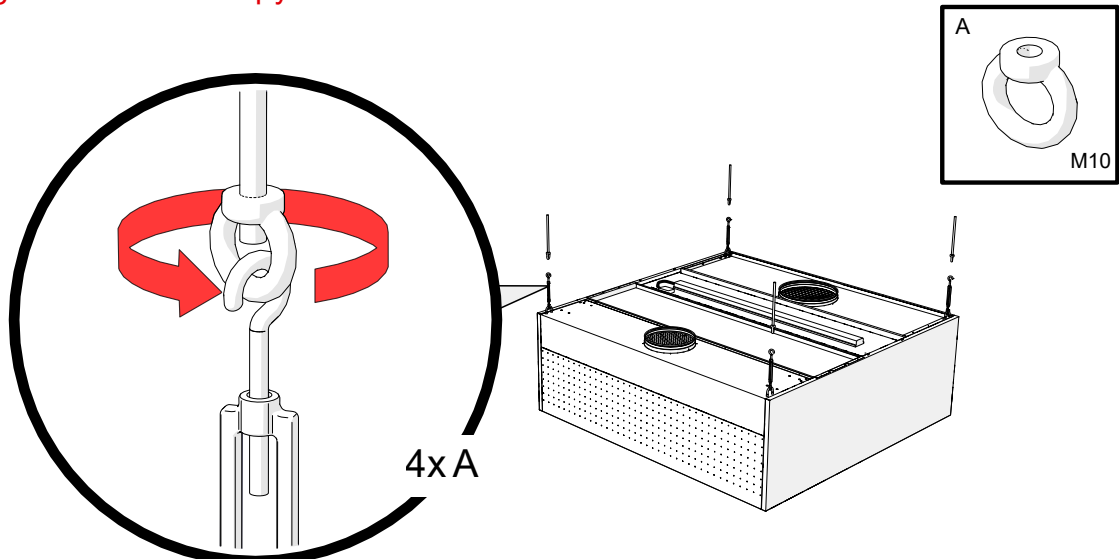

5. Leveling the canopy

Performed for each section.

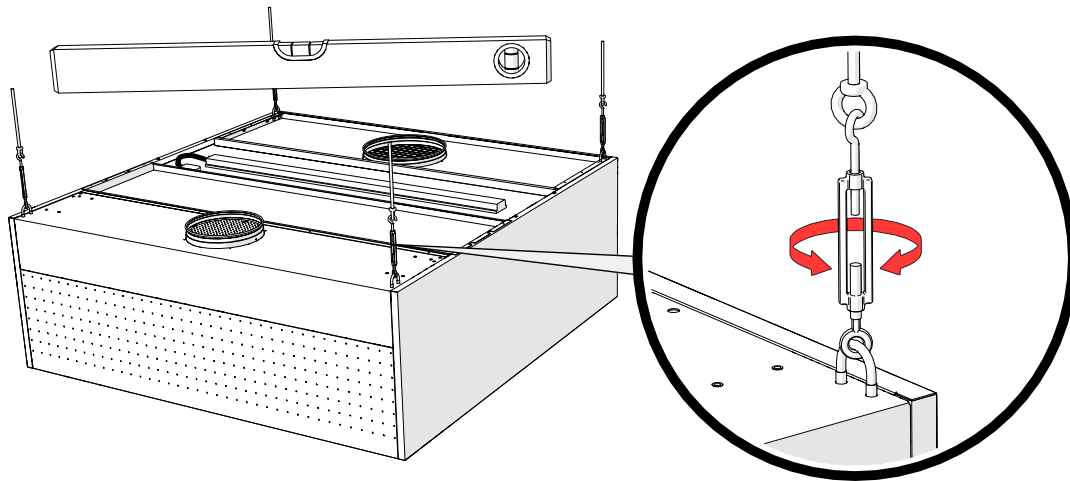

6. Opening the front panel

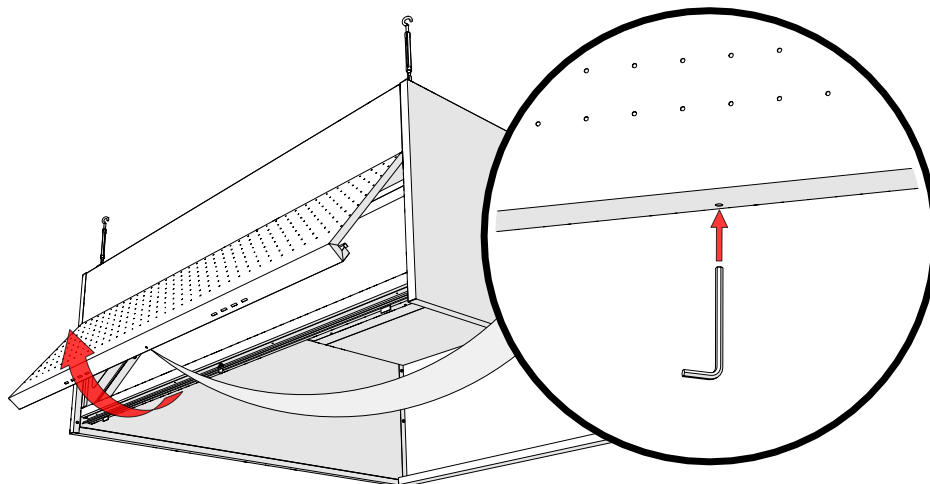

The panel locks automatically.

NB! At the end of the installation, make sure that the panels are correctly fixed.

7. Fastening kitchen canopy sections together

7.1 Hanging the canopy sections side by side

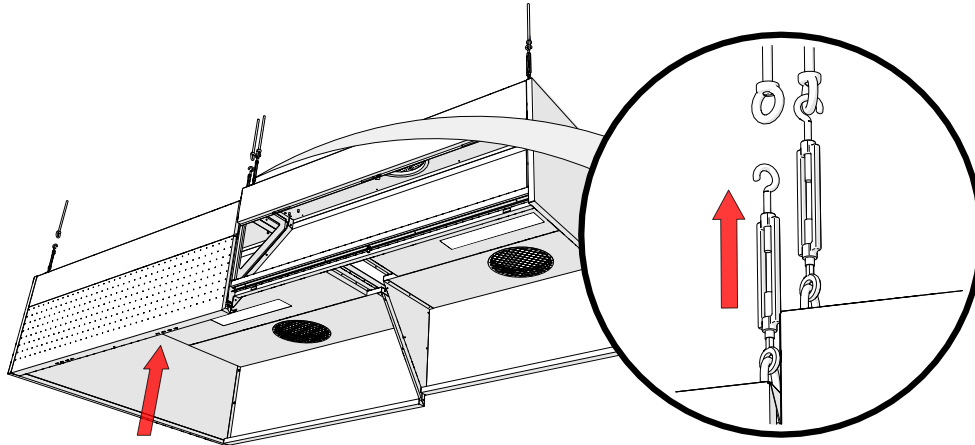

7.2 Sequential connection

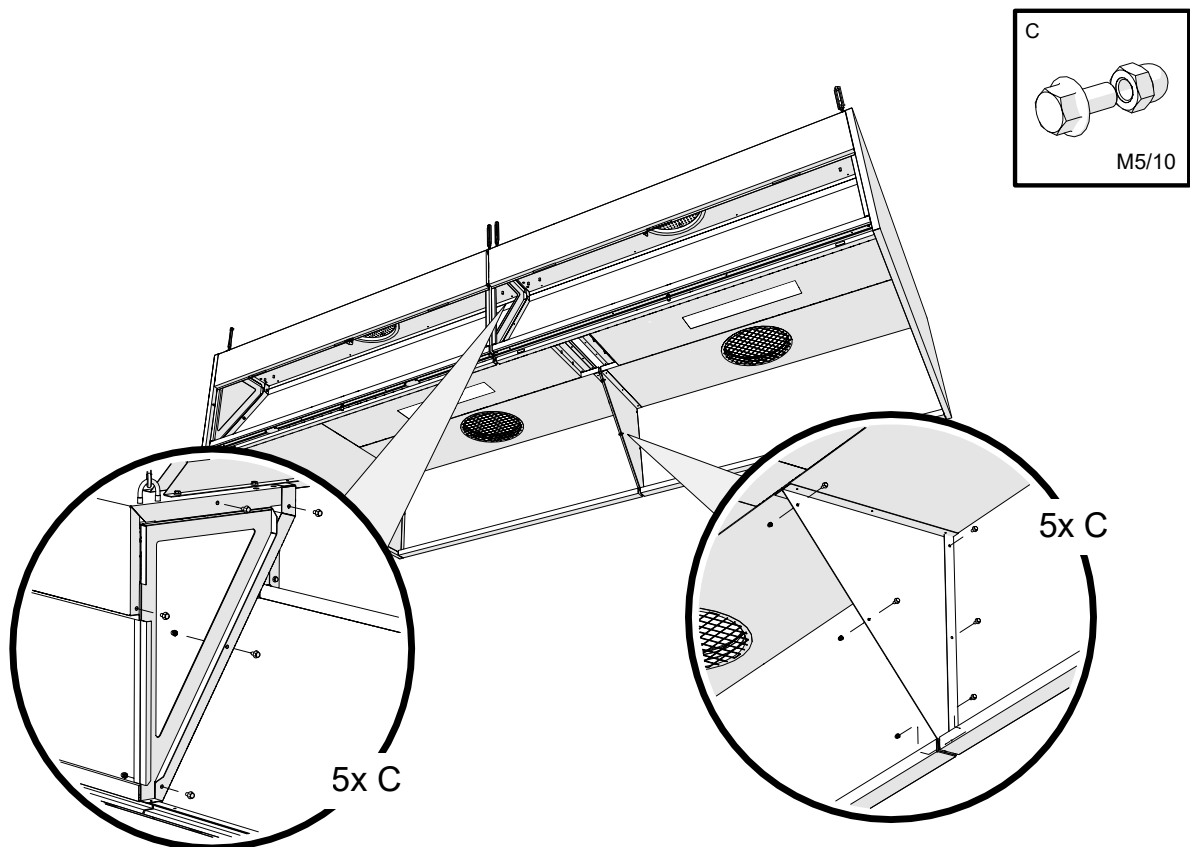

7.3 Installation of the ceiling panel between the sections

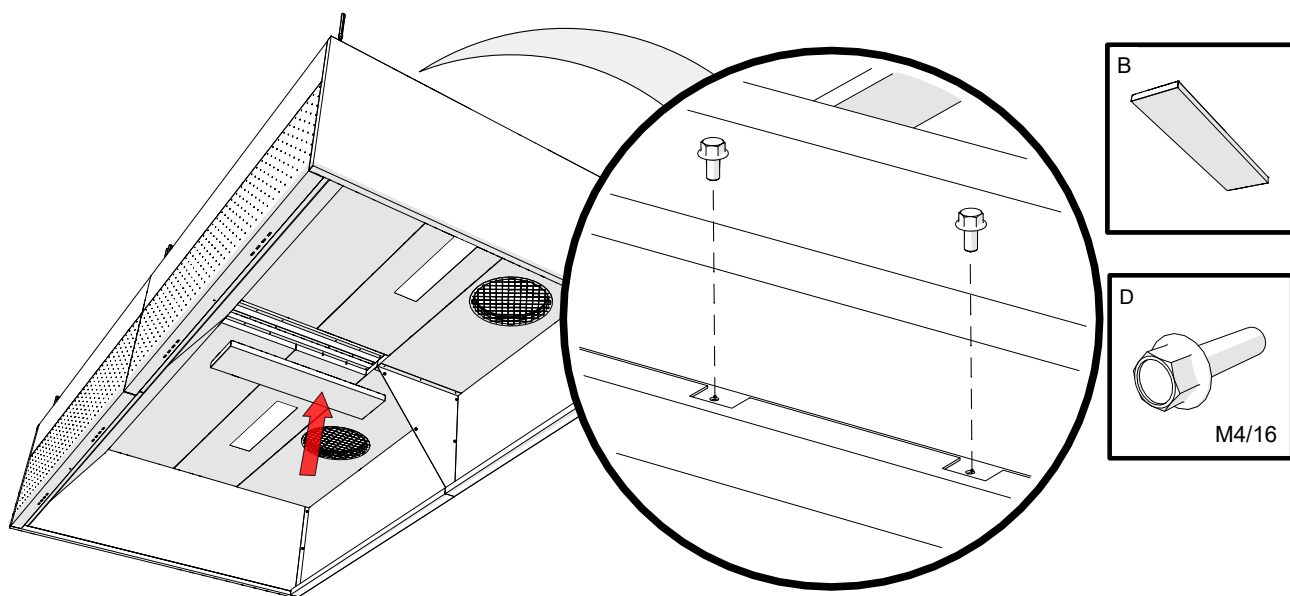

8. Lighting connection

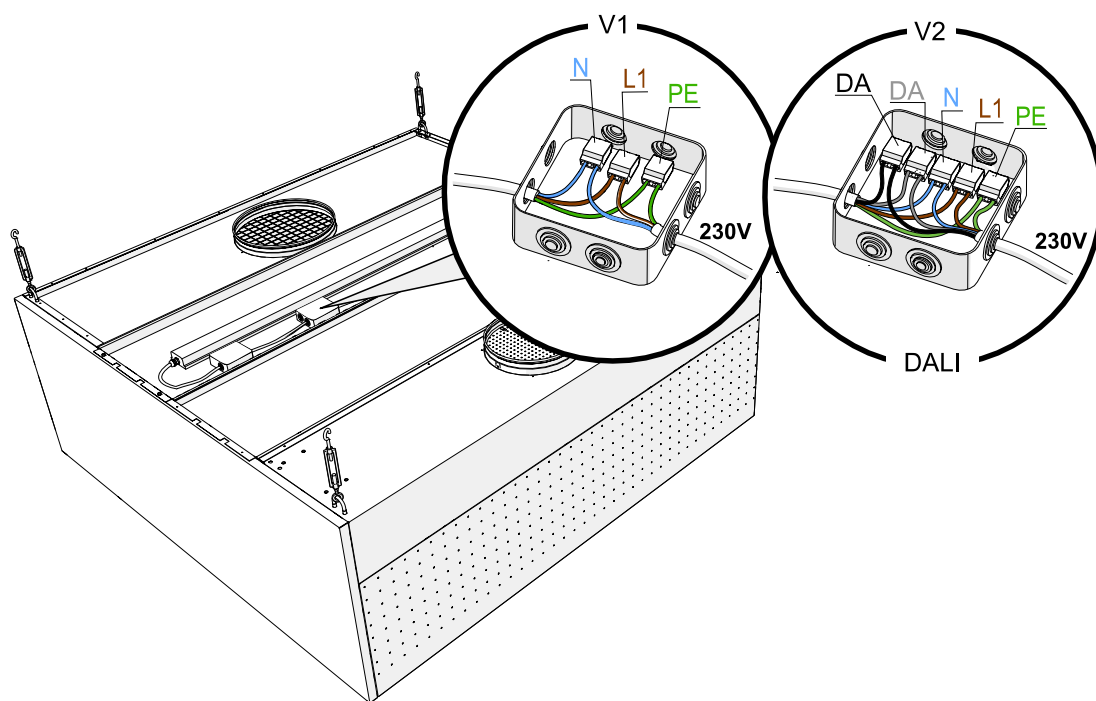

NB! Performed by electrician.

9. Adjusting airflow

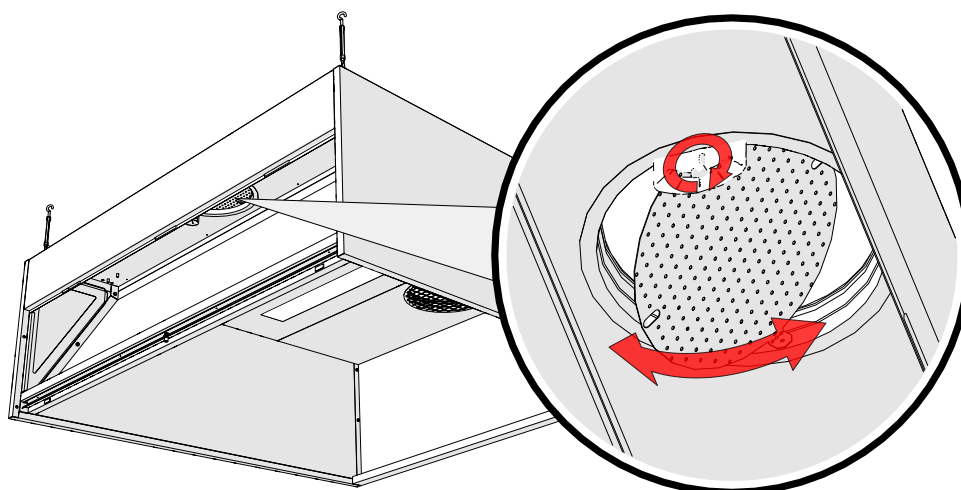

In order to adjust supply airflow, the position of the adjusting plate located in the supply chamber is adjusted. Lock the adjustment plate in place using the butterfly nuts!

K-factor for measuring airflow:

Front panel per 1 m	k-factor
SP×0	2,4
SP×1	19,2
SP×2	32,3
SP×3	50,4

$$Q_v = k \sqrt{\Delta p_m}$$

Calculation example:

Supply air canopy L=2 meter with SP×2 front panel.

Calculation of the supply air volume:

Pressure in the supply air chamber is 26 Pa

Front panel SP×2 k-factor is 32,3

$$Q_v = 2 \times 32,3 \times \sqrt{26} = 330 \text{ l/s}$$

10. Replacing the luminaires

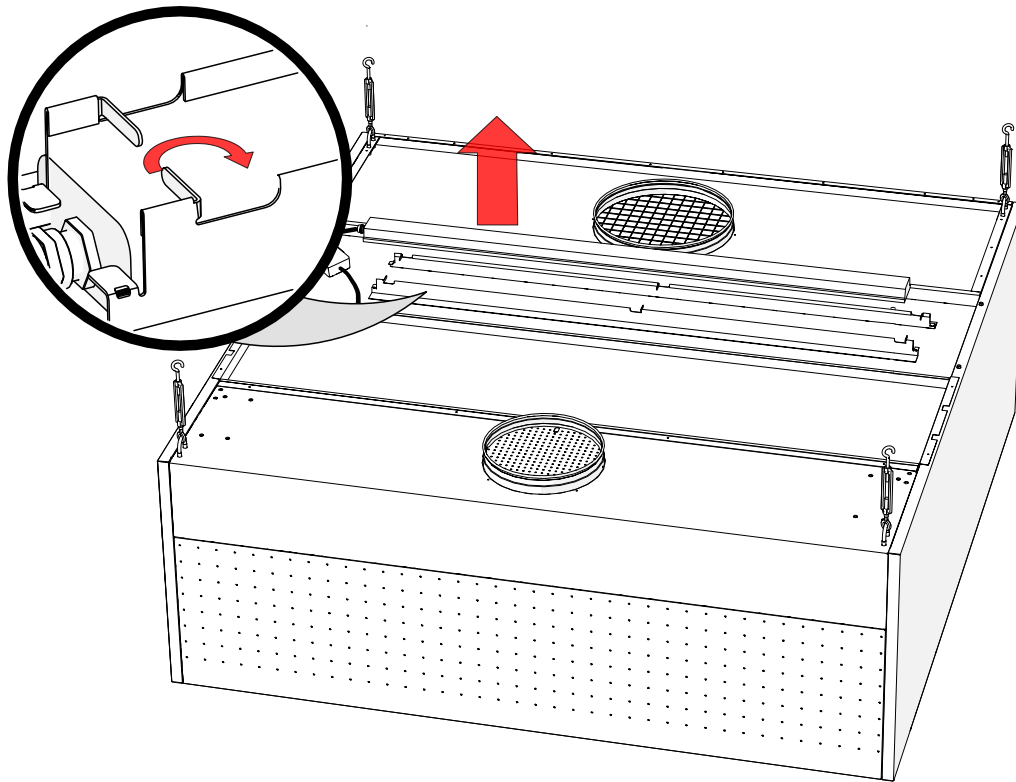

NORDcanopy kitchen canopies use integrated light fixtures with protection class IP 66.
To remove luminaires, bend the ears of the fixing clip away and remove the light.

11. Canopy maintenance

All internal and external surfaces of the canopy, including light fixtures, are cleaned using neutral cleaning agents. Carefully rinse the surfaces after cleaning, in order to avoid harmful interactions of cleaning agents and high temperatures.

NB! Do not use hard or abrasive detergents, chlorine or bleach when cleaning the canopy!
Never clean the canopy when any of its surfaces are hot.

12. Accessories

12.1 Cover plates

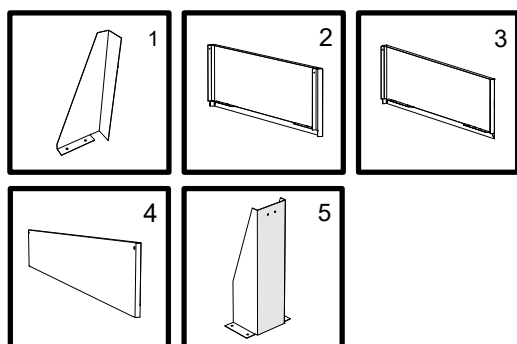
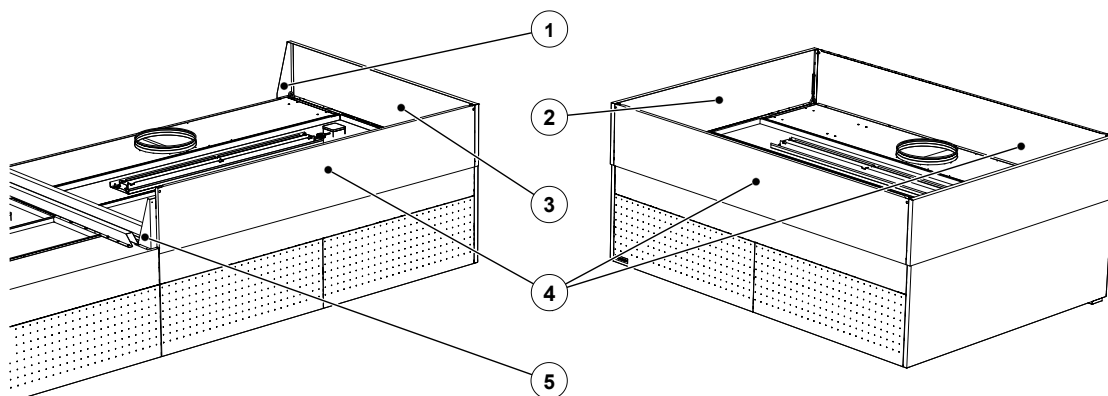

- 1 – Side panel support
- 2 – Island canopy side panel
- 3 – Wall installation canopy side panel L/R
- 4 – Front panel
- 5 – Section beam (sequential connection)

12.2 Installation of cover plates

A – Island canopy cover plates

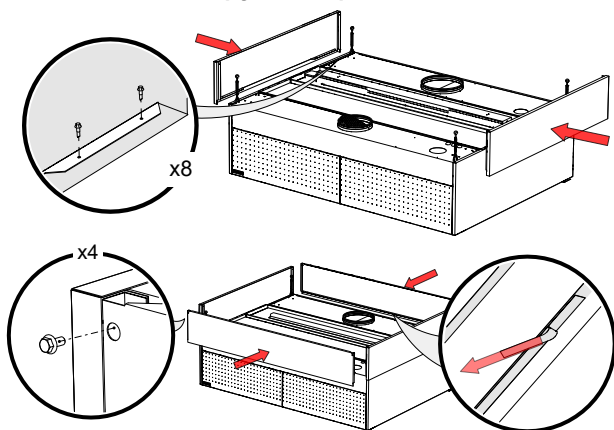

B – Wall installation canopy cover plates

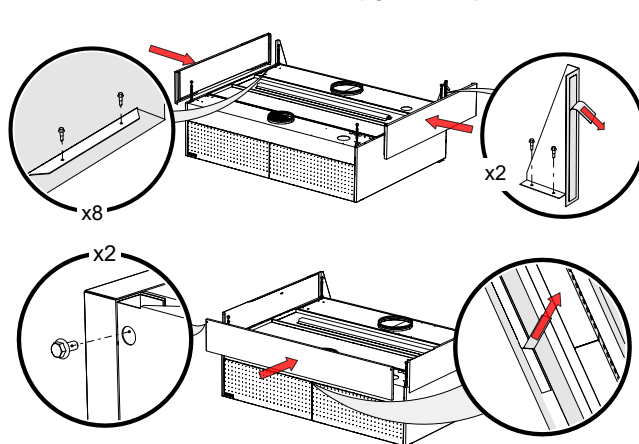

C – Sectional canopy cover plates

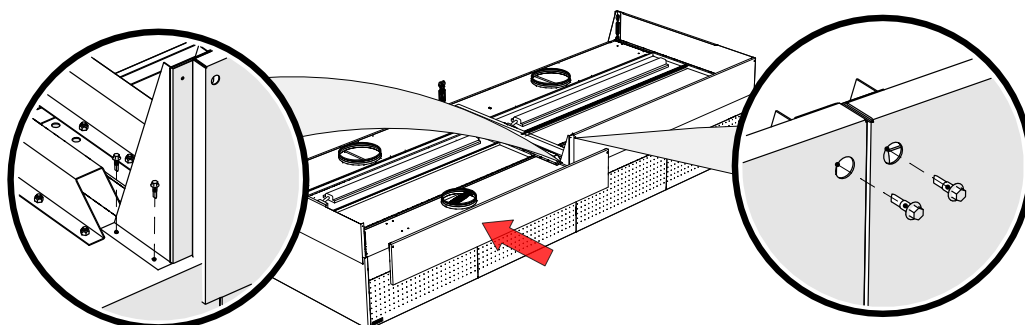



ETS NORD AS

Address: Peterburi tee 53
11415 Tallinn
Estonia
Phone: +372 680 7360
info@etsnord.ee
www.etsnord.ee

ETS NORD Finland

Address: Pakkasraitti 4
04360 Tuusula
Finland
Phone: +358 401 842 842
info@etsnord.fi
www.etsnord.fi

ETS NORD Sweden

Address: Järsjögatan 7
69235 Kumla
Sweden
Phone: +46 19 554 20 50

Address: Pinjegatan 5
21363 Malmö
Sweden
Phone: +46 40-94 68 70

Address: Förrådsvägen 5
151 58 Södertälje
Sweden
Phone: +46 8 550 301 40

info@etsnord.se
www.etsnord.se

ETS NORD International

info@etsnord.com
www.etsnord.com

ETS NORD Ventilation Manufacturing LLC UAE

Sepin Rayo
sepin.rayo@etsnord.com
+971 5257 02916

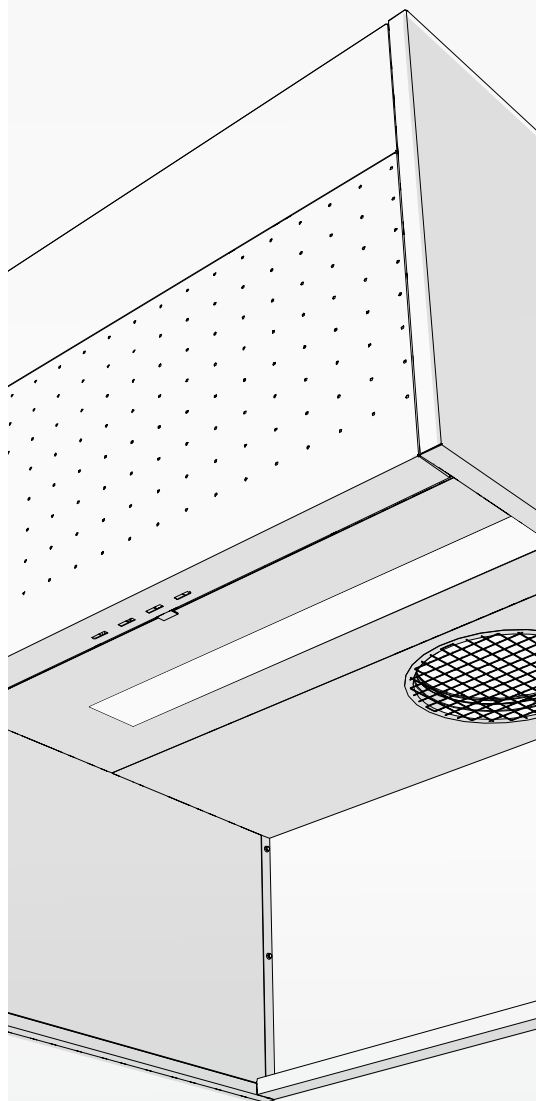

*Let's move the air **together!***